

Schaerer Coffee Vito

Model Freshmilk SCV FM CT1/S-TVO/2MA/ODM/KE
(coffee / hot water / milk)

March 2009



Basic configuration

Spouts: coffee / hot water	1 / 1
Boilers: coffee and hot water (2kW) / steam (2kW)	1 / 1
Grinders / DECAF function	2 / 1
Programmable product selection	up to 15 products
Bean hopper / Water supply	each 1.1 kg / 4.5 l tank
Illuminated panel	Colour of your choice or continually changing

Connections

Voltage / power / fuse protection	230/220/210 VAC, 2.2/1.8 kW, 10 A
Water connection / water outlet (only for models with fresh- and waste water tank)	G 1/2 "max 3 bar / Ø 56mm
Water hardness	5°-7° dh / 8°-12° fh

Dimensions

Width / depth / height	330 / 583 / 814 mm
Weight	about 36 kg

Output per hour (approximate)

Espresso (cup of 50 - 60 ml)	100
Coffee (cup of 120 ml)	80
Cappuccino (cup of 180ml)	60
Latte Macchiato (cup of 200ml)	40

Options

Steam spout
Chute for coffee grounds under counter
Fresh water and waste water tank
Cup warmer or Cup & Cool
Connection to all commercial invoicing systems

Dimensions

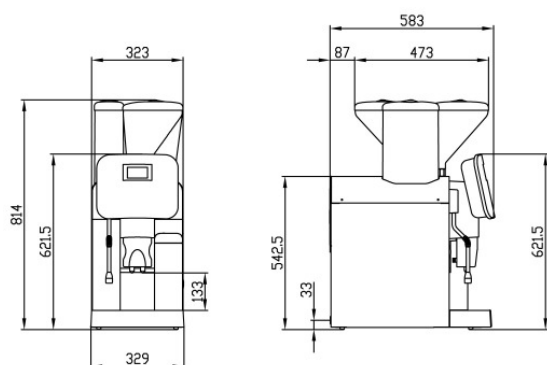

Illustration /configuration may vary from offered machines.

Colours

Illustrations may not reflect actual colour



Kenya, black

M. Schaerer Ltd.
Gewerbstrasse 15
CH - 3302 Moosseedorf
Phone +41 (0)31 858 51 11
Fax +41 (0)31 858 51 40
info@schaerer.com
www.schaerer.com

schaerer
coffee comes to life

Schaerer Coffee Vito

Model Freshmilk SCV FM CT1/S-TVO/C2MA/DM/KE
(coffee / hot water / milk / chocolate)

March 2009



Basic configuration

Spouts: coffee / hot water	1 / 1
Boilers: coffee and hot water (2kW) / steam (2kW)	1 / 1
Grinders / DECAF function	2 / 1
Programmable product selection	up to 15 products
Bean hopper / Water supply	each 1.1 kg / 4.5 l tank
Powder-System for Choco	Choco (1 type of chocolate powder) or Twin Choco (2 types of chocolate powder)
Illuminated panel	Colour of your choice or continually changing

Connections

Voltage / power / fuse protection	230/220/210 VAC, 2.2/1.8 kW, 10 A
Water connection / water outlet (only for models with fresh and waste water tank)	G ½" max 3 bar / Ø 56mm
Water hardness	5°-7° dh / 8°-12° fh

Dimensions

Width / depth / height	330 / 583 / 814 mm
Weight	about 36 kg

Output per hour (approximate)

Espresso (cup of 50 - 60 ml)	100
Coffee (cup of 120 ml)	80
Cappuccino (cup of 180ml) / Latte Macchiato (cup of 200ml)	60 / 40
Moccaccino (cup of 180ml) / Hot chocolate (cup of 180ml)	60 / 60

Options

Chute for coffee grounds under counter
Fresh water and waste water tank
Cup warmer or Cup & Cool
Connection to all commercial invoicing systems

Dimensions

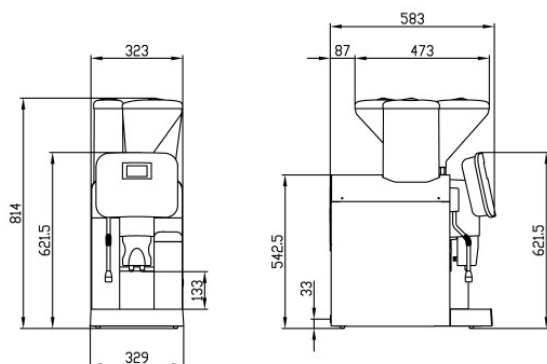

Illustration /configuration may vary from offered machines.

Colours

Illustrations may not reflect actual colour



Kenya, black

M. Schaerer Ltd.
Gewerbstrasse 15
CH - 3302 Moosseedorf
Phone +41 (0)31 858 51 11
Fax +41 (0)31 858 51 40
info@schaerer.com
www.schaerer.com

schaerer[®]
coffee comes to life

Schaerer Coffee Vito

Model Freshmilk SCV FM CT1/S-FWA/C2MA/DM/KE
(coffee / hot water / milk / chocolate)

March 2009



Basic configuration

Spouts: coffee / hot water	1 / 1
Boilers: coffee and hot water (2kW) / steam (2kW)	1 / 1
Grinders / DECAF function	2 / 1
Programmable product selection	up to 15 products
Bean hopper / Water supply	each 1.1 kg / fixed water connection
Powder-System for Choco	Choco (1 type of chocolate powder) or Twin Choco (2 types of chocolate powder)
Illuminated panel	Colour of your choice or continually changing

Connections

Voltage / power / fuse protection	230/220/210 VAC, 2.2/1.8 kW, 10 A
Water connection / water outlet	G ½ "max 3 bar / Ø 56mm
Water hardness	5°-7° dh / 8°-12° fh

Dimensions

Width / depth / height	330 / 583 / 814 mm
Weight	about 36 kg

Output per hour (approximate)

Espresso (cup of 50 - 60 ml)	100
Coffee (cup of 120 ml)	80
Cappuccino (cup of 180ml) / Latte Macchiato (cup of 200ml)	60 / 40
Moccaccino (cup of 180ml) / Hot chocolate (cup of 180ml)	60 / 60

Options

Chute for coffee grounds under counter
Cup warmer or Cup & Cool
Connection to all commercial invoicing systems

Dimensions

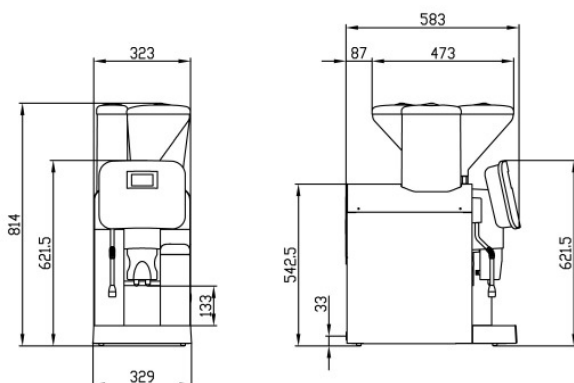

Illustration /configuration may vary from offered machines.

Colours

Illustrations may not reflect actual colour



Kenya, black

M. Schaerer Ltd.

Gewerbestrasse 15
CH - 3302 Moosseedorf
Phone +41 (0)31 858 51 11
Fax +41 (0)31 858 51 40
info@schaerer.com
www.schaerer.com

schaerer[®]
coffee comes to life

Schaerer Coffee Vito

Model Freshmilk SCV FM CT1/S-FTU/G2MA/DM/KE
(coffee / hot water / milk / chocolate)

March 2009



Basic configuration

Spouts: coffee / hot water	1 / 1
Boilers: coffee and hot water (2kW) / steam (2kW)	1 / 1
Grinders / DECAF function	2 / 1
Programmable product selection	up to 15 products
Bean hopper / Water supply	each 1.1 kg / Aquaflex
Powder-System for Choco	Choco (1 type of chocolate powder) or Twin Choco (2 types of chocolate powder)
Illuminated panel	Colour of your choice or continually changing

Connections

Voltage / power / fuse protection	230/220/210 VAC, 2.2/1.8 kW, 10 A
Water connection / water outlet	G ½ "max 3 bar / Ø 56mm
Water hardness	5°-7° dh / 8°-12° fh

Dimensions

Width / depth / height	330 / 583 / 814 mm
Weight	about 36 kg

Output per hour (approximate)

Espresso (cup of 50 - 60 ml)	100
Coffee (cup of 120 ml)	80
Cappuccino (cup of 180ml) / Latte Macchiato (cup of 200ml)	60 / 40
Moccaccino (cup of 180ml) / Hot chocolate (cup of 180ml)	60 / 60

Options

Chute for coffee grounds under counter
Cup warmer or Cup & Cool
Connection to all commercial invoicing systems

Dimensions

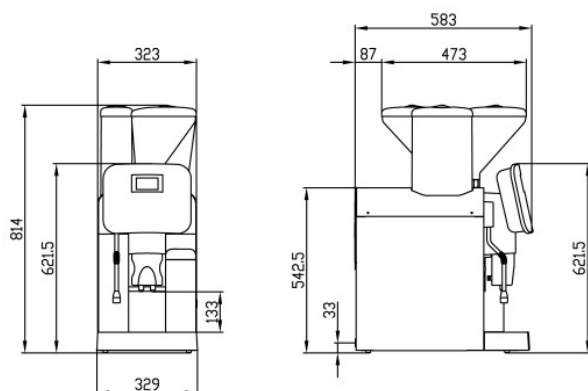

Illustration /configuration may vary from offered machines.

Colours

Illustrations may not reflect actual colour



Kenya, black

M. Schaerer Ltd.

Gewerbstrasse 15
CH - 3302 Moosseedorf
Phone +41 (0)31 858 51 11
Fax +41 (0)31 858 51 40
info@schaerer.com
www.schaerer.com

schaerer[®]
coffee comes to life